



WORLD LEADER IN FLEXIBLE SPACE MANAGEMENT

Summit™

VERTICAL LIFT
OPERABLE PARTITIONS



Summit™ VERTICAL LIFT OPERABLE PARTITIONS

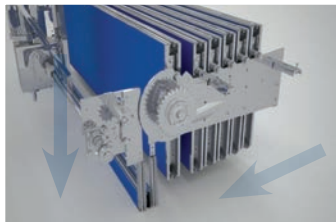

Flexibility has a whole new direction...up.

Hufcor proudly offers the Summit 645V retractable operable wall system. The patented Summit™ system allows individual acoustically rated operable panels to cascade through a narrow slot in the ceiling extending into the opening or stacks them neatly above the ceiling when not needed. The unique, automated lifting device makes achieving optimal space division as simple as pushing a button.

FEATURES & BENEFITS

- **Retracts vertically through and above the ceiling**

Benefit: Floor space is not needed to store the partition when it is not in the opening.

- **Interlocking seals**

Benefit: Maintains acoustics over time, ensures panel-to-panel alignment, and adds stability to the partition when extended.

- **Contact Sensor Seal**

Benefit: Safety—Stops the downward movement and reverses the partition if it should encounter a person or object.

- **Vertical Guide Rails**

Benefit: Reduces moveable parts and the need for separate motors to seal panel into opening.
Benefit: Easy access to operating guide rollers and safety limit switches for inspection or should repairs or adjustments be needed.

- **Safety Systems**

Benefit: Per UL325, Summit contains primary and secondary safety systems in the event a single safety system would fail.

- **Manual override of motor units**

Benefit: Panels can be moved if there is a power failure.

- **Electronic, automatic operation**

Benefit: Automated operation – reduces setup and operational training time.

- **Durable welded steel frames**

Benefit: Proven durability in tens of thousands of Hufcor installations globally.

- **Single panel construction**

Benefit: Fewer moveable parts and aesthetically more appealing, creating a “wow” factor.



Panel Construction

Panels are a nominal 4" [102] thick and to 33" [838] in height. Panel faces shall be steel laminated to appropriate substrate to meet the STC requirement. Welded steel frames are of 14 gauge [1.90] painted steel. Panels have no horizontal face trim, providing a monolithic appearance.

Summit is available in heights to a nominal 17'6" [5.33m] and partition opening widths to a nominal 40' [12.2m]. Contact your Distributor for openings exceeding these dimensions.

Seals

Sound seals shall be of tongue and groove configuration, ensure panel-to-panel alignment and prevent sound leaks between panels.

Horizontal panel edges shall provide a minimum groove appearance.

The first panel in the opening shall have a bottom retractable safety sensor seal providing a minimum of 2" [51] floor adjustability to accommodate out-of-level floors.

Finishes

The standard face finish is factory-applied vinyl; however, optional carpet, fabric, full height marker board, architectural fusion laminates, rotogravure baked polyester steel and other custom finishes are available, subject to factory approval for manufacturing compatibility.

Exposed metal trim is powder coated in Lamb's Wool, Gray, Brown, or clear anodized aluminum. The vinyl seals are available in Lamb's wool, Gray or Brown. Custom metal trim colors are available for an upcharge.

IMPORTANT NOTE ABOUT FACE FINISH DIRECTION: Finishes will be applied to the Summit IN A HORIZONTAL DIRECTION. The finishes provided on most selectors or samples are shown in a vertical position and may look different when applied horizontally.

Motor and Drive System

Panels shall stack on steel drive box above the ceiling and be lowered into the opening via gravity feed operation. The motor and drive system shall automatically extend/retract the panels in the opening by activating the key-switch control.

Each panel shall be supported by two guide rollers traveling in vertical guide rails.

Power unit and controls shall be UL listed. Motor shall have adequate horsepower to operate partition effectively. Partition shall be operated by one control station wired in series. The key station requires human contact to be activated, ensuring safe, supervised operation of the partition system.

Safety Systems

Adherence to UL325 primary and secondary safety systems required. When the operable wall is being lowered (closed), the panels shall stop and reverse a few inches if the leading (bottom) edge comes into contact with an obstruction. The operation of the wall may resume once the obstruction is cleared and the key switch has been reset.

Acoustics

The partition has been tested at a laboratory accredited by the National Voluntary Laboratory Accreditation Program (NVLAP) and in accordance with ASTM E90 Test Standards shall have obtained a minimum STC rating of 51.

Weight

Weight of the panels shall be 10.9 lbs. per sq. ft. [53.2 kg/sq m],

Seismic

The systems must be tested to withstand seismic movements and designed per Building Code SEI/ASCE 7 for site class D, Category III at a minimum.

ISO Registration

Hufcor's U.S. manufacturing facility's quality systems are registered to the ISO 9001 standards.

Warranty

Summit Series 645V partitions are guaranteed for two years against defects in material and workmanship, excluding abuse.

Details and editable specifications can be downloaded from Hufcor's website, www.hufcor.com. Complete specifications and details may also be found in our Architectural Product Manual. BIM Model also available. Contact your local Hufcor Distributor for assistance.

645V SERIES VERTICAL SECTION

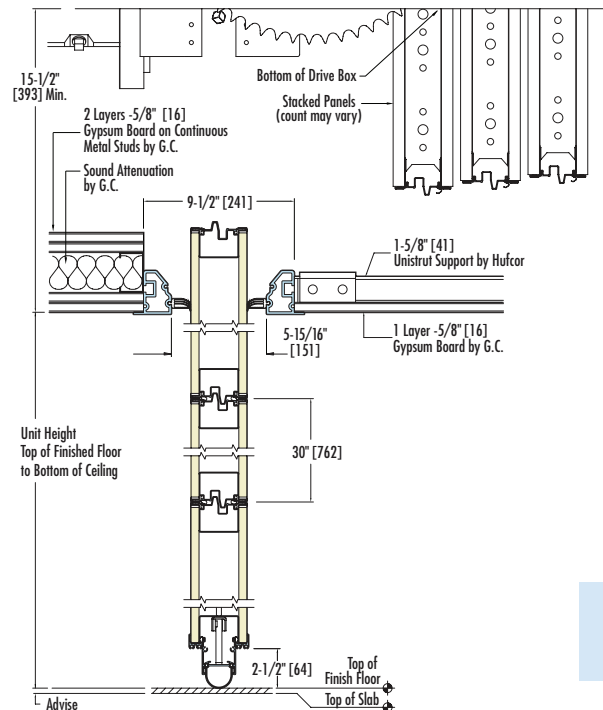

645V HORIZONTAL SECTIONS

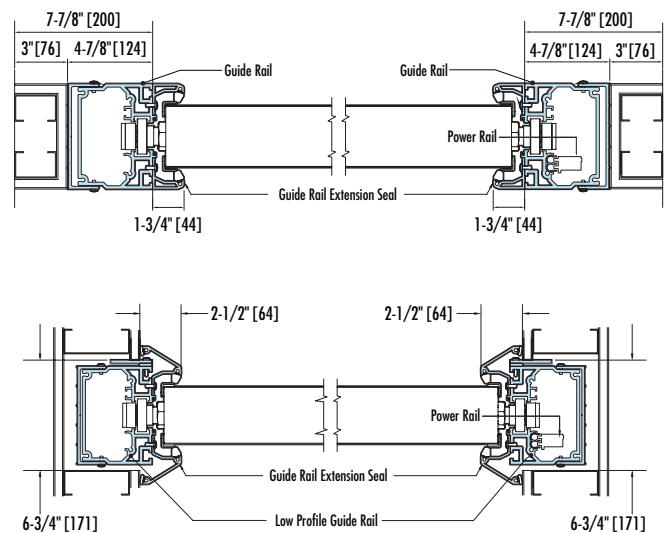

BIM REVIT® FAMILIES AVAILABLE FOR THE 645V SUMMIT.
CONTACT YOUR LOCAL HUF COR DISTRIBUTOR FOR ASSISTANCE.

Note: Metric dimensions in [] are in millimeters unless otherwise indicated.

Choose Hufcor

AND CHOOSE PARTITIONS THAT ARE KNOWN WORLDWIDE FOR QUALITY AND VALUE.



OPERABLE



GLASS WALL



ACCORDION



BI-FOLD

Partitions must control sound. We test our products in our sound laboratory to make certain they meet or exceed our published acoustical ratings. The laboratory is certified by the National Voluntary Laboratory Accreditation Program (NVLAP) and, like our ISO certification, we undergo regular inspection to make certain we adhere to their strict regulations. And, although it isn't required of us, we also hire an independent consultant to witness and verify any test results.

Worldwide Availability. Hufcor's U.S. manufacturing facility is located at our headquarters in Janesville, Wisconsin. In addition, Hufcor products are manufactured in Australia, Brazil, Canada, China, Germany, Japan, Malaysia, Mexico, Russia, South Africa, Spain, and the United Arab Emirates. Hufcor products may be purchased through a network of authorized Distributors located throughout the world. Check our website or call for the name of your nearest representative.

Renovation and Repair. Not only do we provide new products, we also offer retrofit service for Hufcor products and those manufactured by others. Contact your local Hufcor representative for a free analysis of your needs.

Leasing Program. You may wish to consider the option of buying partitions through a lease program. Check with your accountant to see if leasing vs. a lump sum payment will provide you with financial benefits.

Hufcor Custom Delivery. If you need to pinpoint the delivery date and time (which is often critical for renovation projects), we can do it. In the U.S., our fleet of vans can deliver your order on time and without damage that can occur when shipping by other methods.

innovation
YOU GET MORE WITH HUFCOR



World Leader in Flexible Space Management™

WORLDWIDE HEADQUARTERS

PO Box 5591 / 2101 Kennedy Road, Janesville, WI 53547
Toll-Free: 800-542-2371, ext. 214 Telephone: 608-756-1241
Fax: 608-758-8253 E-mail: info@hufcor.com
www.hufcor.com

The Hufcor Commitment to Green Manufacturing, Sustainability and LEED™. Hufcor is committed to being an industry leader when it comes to protecting the environment by reducing pollutants and minimizing our environmental impact on air, water and land. For over a decade Hufcor has utilized a "Green" approach to manufacturing and energy consumption and has increased the percentage of materials that we recycle, reuse, repair, restock or return for salvage. Today, the Hufcor commitment and progress toward Green manufacturing is greater than ever as we continue to develop standards that support various LEED™ (Leadership in Energy and Environmental Design) points to assist the achievement of LEED certification goals.

IT'S ALL IN THE BOOK

More details on all Hufcor products are available in the Architectural Product Manual. Call your local rep today to receive a complimentary copy. Or visit www.hufcor.com to sign-up for the interactive digital version.



see us at
Sweets.com

Hufcor has a program of continuous product improvement. As a result, some products may be modified from those represented in this catalog.

Hufcor Partition U.S. Patents:			
2,861,660	3,056,193	3,223,147	3,295,257
3,295,588	3,450,185	3,638,376	3,755,968
3,783,930	3,879,799	3,042,960	4,014,137
5,181,296	5,230,123	5,406,676	5,481,834
5,564,759	6,112,466	6,167,937	8,468,751



The quality systems of Hufcor's U.S. manufacturing facility is registered to the ISO 9001 standards.



*USGBC and related logo is a trademark owned by the U.S. Green Building Council and is used by permission.



Hufcor offers continuing education programs for AIA members. Contact your Hufcor representative for details.